

# Installation Notes

**Model's: FW 584 & WR 584**

Door Opening: 57.25" x 73.5"

Front Outside Threshold Height: 3"

Inside dam height: 1.5"

## Installation Notes:

1. Inspect Frame Area for proper size, level, square and plumb
2. Position module in framed pocket. Check to be sure module is plumb and level. Be sure apron is down tight to floor and walls are touching studs of framed area.
3. Spot nail the nailing flanges at the lower front corners.
4. Continue to nail - approximately 8" on center starting from the bottom and working to the top of the side wall nailing flanges. Nail the top flange to each stud.
5. Starting from the finished side, drill or hole-saw plumbing hardware holes. Double check hole locations prior to drilling.
6. After installation – clean base with warm water and liquid detergent. Paints and other materials may easily be removed without damage to the unit with use of turpentine, paint thinner or acetone.
7. Any scratches or dull areas in the unit may be removed with automotive type buffing compound.

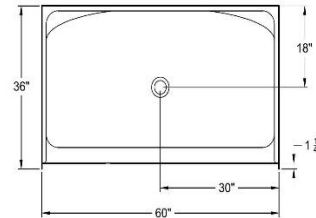

FW 584 and WR 584

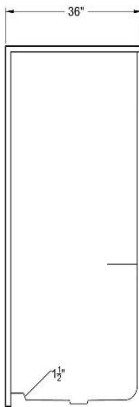
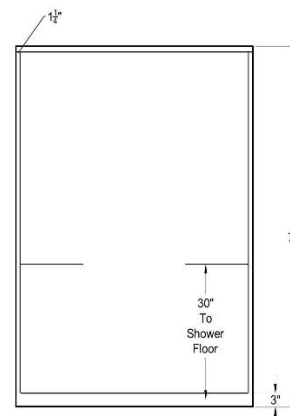

4-23-19

## Special NOTE:

**ALL DIMENSIONS MAY VARY +/- 1/4"**

